

Filter mod. 15x40”

INSTRUCTIONS FOR USE

General Information

The described equipment has been designed, constructed and tested in conformity with P.E.D CE 97/23. The company reserves the right to make the necessary modifications to improve the product without notice. Before installing and using this product it is necessary to read carefully the following instructions. Any use not contained in the present description is to be intended as improper and dangerous for people, things and environment, thus the warranty will be considered not valid forthwith. We suggest that use and maintenance of this product are made by skilled personnel, expressly trained for this purpose.

Description

The present equipment is a container for filtering cartridges (afterwards called filter) whose purpose is to make a filtration of the fluid going through it. The grade of filtration depends exclusively on the characteristics of porousness of cartridges; also capacities and charge losses are closely linked to the characteristics of filtering elements.

In order to know the application of this filter, consider a maximum capacity of 60 MC/H with melt-blown polypropylene cartridges with a grade of filtration of 5 micron. In these conditions, you can consider only the charge losses due to elements filtering almost 0,15 bar.

Technical Data

The filter 15x40” is supplied to be used with not dangerous liquids only, belonging to PED article 9 group 2, thus it does not have to bear CE marking, as per the article 3.3 of PED 97/23/EC.

The filter has been designed to contain liquids classified as ‘Not Dangerous’ and, in any case, compatible with inox steel AISI 316L of which it is made up.

IN/OUT Connections: DN 100 PN 10 with free flanges moulded in AISI 304 and thick collars

Feeding connection placed on planking

Output connection placed on inferior bottom

Drainage: Sleeve ½” BSP

Air vent: Sleeve ½” BSP

Upper cap: Bottom with flanges

Fixing: 12 fixed screws M10 with 12 female ringbolts inox M10

Supports: 4 dismountable legs in inox metal sheet AISI 304 with regulation and ground fixing feet

Filter Handling

The filter is packed on pallet with polystyrene saddles.

The legs are dismounted, packed with pluriball and fixed to the filter with metal hoop-iron.

Pay attention to whiplash when cutting the hoop-iron, do not expose face or hands when it leaps.

Mount the legs maintaining the filter horizontally laid, then pick it up with the aid of a pulley.

Filter Installation

The handling of the filter and its installation must be done by skilled personnel equipped with personal protection aids such as gloves, shoes and any other thing required by the laws in force.

Control the presence of all parts necessary to the installation of the filter.

The manual handling of the empty filter requires the presence of more than one person; when the filter is full its handling is forbidden.

Fix the filter to the ground with proper plugs (M8) of a length of no less than 10 cm if fixed on a C.A. floor or by passing screws with a counter-nut if fixed on a metal frame.

When you have fixed the filter in the work position, link the pipes to the input and output flanges.

Pipes must be auto-supporting, i.e. they must not transfer charges to the filter.

The packaging must be disposed of following laws in force.

The filter can work up to a maximum pressure of 10 bar but, for this reason, must be protected from accidental overpressures with proper security systems.

Before starting the filter, open it and remove the red disc which fixes the poles supporting the cartridges.

The poles supporting the cartridges are independent from one another, i.e. each pole has its own incision for the cartridge support.

To prevent the poles from being damaged during transport from possible bumps, they are fixed at their ends by a red fibre disc, perforated next to each pole. To remove the disc, screw off all the upper engravers of every poles and remove the fibre disc.

Cartridges Insertion

The poles length fit all filtering cartridges type DOE (double open end) 40" length 1016mm or a series of two 20" cartridges or four 10" cartridges if provided with proper interconnectors.

Insert the cartridges on each single pole and screw up the engravers up to incise the filtering material of the cartridge or its gasket if there is one.

Make sure that the O-ring of the upper flange is placed in its right position.

Close with the upper cover and tight all the twelve ringbolts (in a crossed way), for several times.

The filter must have an air vent upper valve and a drainage lower valve.

Starting

Slowly open the input valve to fill in the filter, keeping the air vent valve open to let the air inside the filter go out. When only liquid comes out from it, close the air vent valve.

Slowly open the output valve.



WARNINGS

NEVER LOSE THE CLOSING RINGBOLTS WHEN THE FILTER IS WORKING OR UNDER PRESSION.

Before opening the filter, always close the feeding valve and then the output valve.

Drain the liquid through the drainage, opening also the air vent valve to let air enter in the filter.

Open the upper cover only when the filter is empty and without pressure and when the IN/OUT valves are closed and drainage and air vent valves are open.

FILTER CARTRIDGE 15X40"

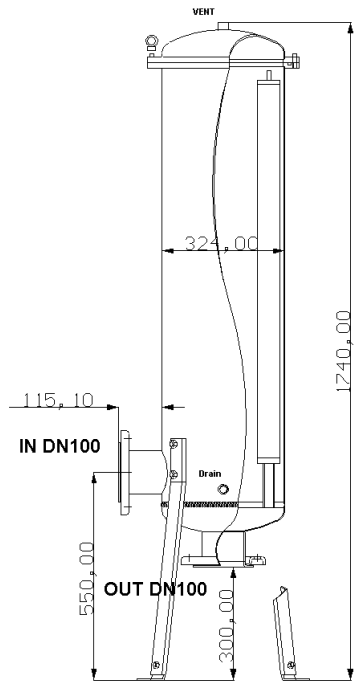

TECHNICAL

Material: AISI 316L EH1.4404

Connection: Inlet Flange DN100/PN10

Outlet Flange DN100/PN10

Vent: 1/2" BSP

Drain 1/2" BSP

Weight: 80 Kg

Surface finishing: ceramic blasted

Operation Pressure: max 10 bar

Operating Temperature: max 80 °C

Cartridges type: DOE 40" long

pieces 15

PEB: Art. 3 parag. 3

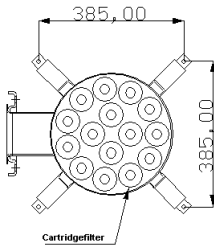

CODE: NP-F15X40DN

S.S. MULTICARTRIDGES FILTER-HOUSING (Size: 15 cartridges X 40")

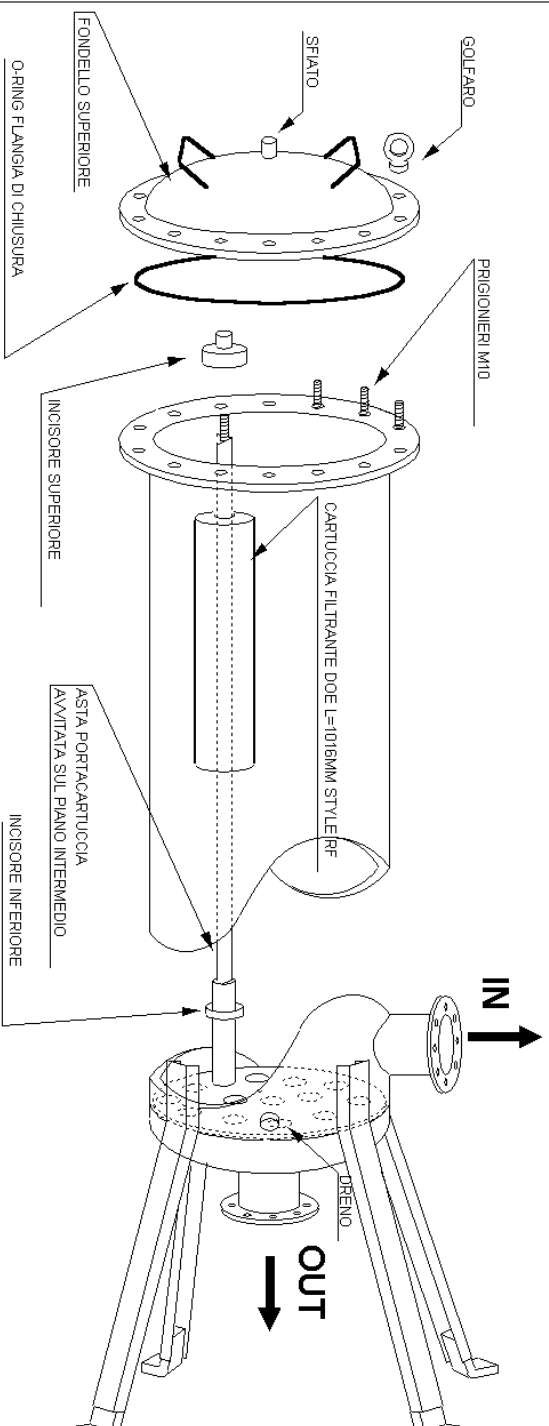

PURO

Code: WP-F1540DN

**WARNING**

ONLY FOR THE EUROPEAN
COMMUNITY MEMBERS

THESE FILTERS ARE FREE OF THE "CE" STAMP SINCE THEY ARE INCLUDED
IN THE ARTICLE N°3 PARA 3 OF THE P.E.D. 97/23/CE OF 29 MAY 1997.
THESE FILTERS CAN BE USED ONLY WITH THE FLUID AND IN DESIGN THAT
RESPECT THE CONDITIONS ESTABLISHED BY THE DIRECTIVE ABOVE MENTIONED
AS SHOWN IN THE FOLLOWING:
- ARTICLE N°9 FLUID CLASSIFICATION PARA 2.1-2.2-3
- ARTICLE N°3 TECHNICAL REQUIREMENTS PARA 1-1 LETTER B

MODEL: WP-F15X40DN

CODE AND STANDARDS

Calculation:	Internal WP Code
"CE" Stamp	not applicable

DESIGN DATA

Fluid categorie:	2
Design temperature:	80 °C
Design pressure:	10 Bar
Hydraulic test pressure:	15 Bar

MATERIAL OF CONSTRUCTION

All wetted parts:	AISI 316L
Gasket:	EPDM
Chamber Diameter	324 mm
Chamber volume	96 Lt
IN/OUT:	DN100 PN10 Flanged

SURFACE FINISH

Internal treatment:	Glass blasted
Outside treatment:	Glass blasted

CARTRIDGES

Type:	DOE
I.D. min/max:	26/30 mm
O.D. max:	70 mm
Length max:	40" (1016 mm)
Nr of cartridges:	15

Melt blown, wound, pleated and washable net's cartridges